



PROXIMITY OF STARKER AED7000 CAN SAVE LIVES

All clinical studies demonstrate this : during a sudden cardiac arrest, the speed of intervention increases the chances of life of the patient: Starker is accessible to the general public without prior training. Companies, public places, collective and sports arenas, cafés, hotels, restaurants, campgrounds, ambulances, and family houses.

Starker provides first aid, in case of sudden heart attack, waiting for the arrival of the rescue, after having called emergency number **112**.

These few minutes are vital.



STARKERDAE7000

STARKER DAE 7000

Starker's analytical technique integrates the patient's cardiac rhythm, physical condition, determines whether defibrillation is necessary, and strength, reducing the risk of injury. Starker guides the user with a clear voice in English, to perform the step-by-step procedure. It ensures that the treatment is performed correctly while protecting the operator.

Starker distinguishes between ventricular and other tachycardia. Correctly connected to a patient, even unconscious, with very little breathing, Starker analyzes, pronounces audio instructions, determines whether a shock situation is necessary, prepares the load and rhythms heart massage by beeps.

Its "intuitive and user-friendly" mode of operation makes it very efficient. Delivered with a simple instructions in English, including pictograms, it provides an evident understanding of the process to be followed to save a life.

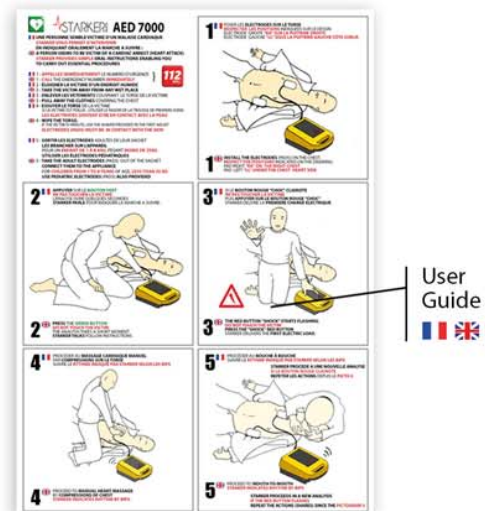

STARKER AED7000

Very light (2 Kg), sized like an A4 sheet, in its ergonomic and resistant carrying case, Starker comes with :

2 pairs of single connector electrodes (one adult + one pediatric), self-adhesive and pre-gelled, of low impedance, Starker can treat all patients.

Its lithium battery supplied, guaranteed 5 years from its start, delivers up to 120 shocks to 150 joules.



STARKER DAE 7000	
Dimensions	303 x 216 x 89 mm
Weight	2.0 kg
Auto-Test System	Several times a day
ENERGY SEQUENCE	
- Adult	100, 150, 200J
- Pediatric energy reducer	50% à 25 Ω
- Energy attenuation factor	25% à 50Ω et 75Ω
	20% à 100Ω et 125Ω
	15% à 150Ω et 175Ω
DEFIBRILLATOR	
- Waveform	Bi-phasic Truncated exponential
CHARGING TIME	
- New Battery	Typically 150 J in less than 8 seconds, 200 J in less than 12 seconds
- After six discharges	Typically 150 J in less than 8 seconds, 200 J in less than 12 seconds
PATIENT ANALYSIS SYSTEM 10 sec	
- Method	Evaluate the patient's ECG, signal quality, electrode contact integrity, and patient impedance to determine whether degradation is necessary
- Specificity	Complies with ISO 60601-2-4
DOCUMENTATION OF EVENT	
- Data Système	Internal memory
- Memory capacity	280 minutes of ECG and event / incident recording and 15min sound record
- Reading capabilities	Custom Infrared connected directly to the PC and data review software under Windows AED_ReviewSoftware
ENVIRONMENT	
- Operating temperature	0° C à 40° C (+32° F to +104° F)
- Temporary transport temperature	-20° C à 55° C (-4° F to +131° F) up to two days. The unit must be returned to standby / use temperature for 24 hours before use
- Relative humidity	0 % à 90 % (non-condensing)
- Waterproofness	IEC 60529 / EN 60529 > IP56
- Altitude	-30 à +3 600 meters (-100 à +11 800 FEET)
- Shock	IEC 68-2-27; 100G
- Vibration	MIL Std. 810F T
- EMC	EN 60601-1-2 and EN60601-2-4
- Radiated Emissions	RF emissions CISPR 11
- Protection against electrostatic discharge RF	EN61000-4-3 80MHZ-2.5GHZ (20 V / m)
- Protection against distortion of the magnetic field	EN61000-4-8 (3 A / m)
- Fall height	1 meter (3.3 ft)
USED MATERIALS	
- Cockpit	ABS
- Pads	Hydrogel, silver, aluminum, polyester
PADS ADULTS (EDC-1035) - PEDIATRICS (EDC-P135) CERTIFIED CE	
- Duration of storage	2 years from date of manufacture
- Weight	0,2 kg (0,44 pounds)
- Size	105 mm x 155 mm x 2,4 mm (4,13 in x 6,10 in x 0,94 in)
- Pads positions	Antero-lateral (adults) ; Antero-posterior (kids)
- Active gel zone	8,3 cm ² (12,9 inch)
- Cable length	120 cm (3,9 ft)
NOT RECHARGEABLE BATTERY 15V D.c 2.8Ah	
- MSD	Non dangerous certificate CR17335E-R CR17450E-R CF224248
- B Type	Lithium-Manganese-Dioxide (LiMnO ₂)
- Capacity	>100 shocks to 200J
- Garanty	5 years from battery plugged